

## Daily — Quick Clean

Perform daily for optimal performance

1. Place an empty 12oz cup on the drip tray
2. Select "**Quick Clean**" from the main menu
3. Choose **Brew Line Wash**
4. Repeat steps, but choose **Soluble Line Wash**

## Daily — Removing Milk Nozzle for Cleaning & Sanitization

Turn off the brewer. Remove the nozzle cover housing by sliding it forward out of the holder **(A)**. Pull down to remove the milk nozzle **(B)**. Uncap the milk nozzle for **cleaning and sanitizing (C)**.

To reinstall, replace the milk nozzle, and slide the cover housing back into its holder.

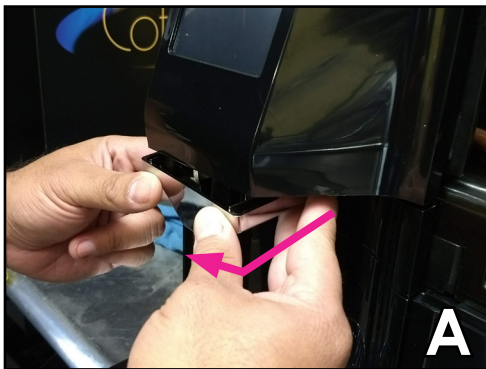

## Weekly — Removing the Mixing Bowl and Powder Hoppers

Lift the hopper cover. Start by rotating spouts on the powder hoppers to the horizontal position **(1)**. Push forward then lift up the powder hoppers **(2)**. Next, disconnect the milk tube from the front of the mixing bowl **(3)** and unlock the mixing bowl by turning the green tab to the right **(4)**. Pull out the mixing bowl. Set aside the mixing bowl and empty powder hoppers for **cleaning and sanitizing**.

To reinstall, reassemble the mixing bowl parts and slide the assembled bowl back into its original position. Lock the mixing bowl by rotating the green tab all the way to the left. Reconnect the milk tube to the mixing bowl by pushing the milk tube about ½" onto its connector. Replace the powder hoppers. Close the hopper cover.

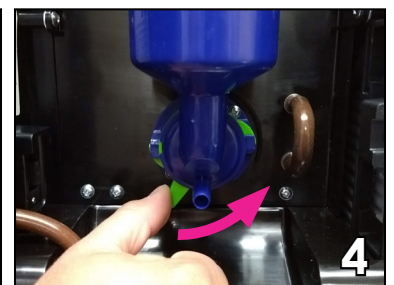
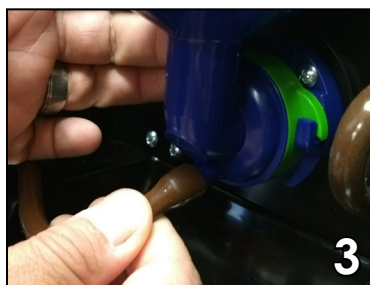
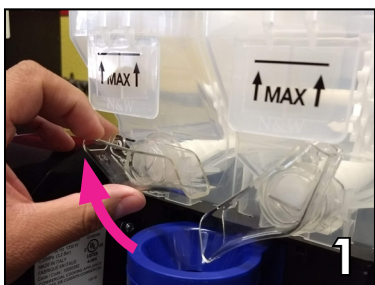

## Cleaning & Sanitization (recommended weekly)

Applicable items include: K-Cup bin, drip tray, mixing bowl, hoppers and nozzle.

### Step 1. CLEAN

Urnex Rinza Alkaline Milk Frother Cleaner  
Item # RIN-MFSSC1

#### 1. PREPARE

Prepare diluted solution of Rinza, Mix well and use immediately.



15oz Rinza Concentrate + 2 Gallons Warm Tap Water

#### 2. SOAK FOR 30 MINUTES

Soak parts in Rinza solution for 30 minutes. If parts cannot be removed, then dab a soft cloth into the Rinza solution and use it to coat appliance part.

#### 3. RINSE

Remove parts from solution and rinse well using tap water to remove cleaning residue. If parts were not removed from the appliance, wipe well with a soft cloth dipped in tap water.

### Step 2. SANITIZE

Urnex Complete Café Equipment Sanitizer  
Item # URN-CC1

#### 1. PREPARE

Prepare diluted solution of Complete Café. Mix well and use immediately.



0.5oz Complete Café Concentrate + 2 Gallons Warm Tap Water

#### 2. SOAK FOR 1 MINUTE

Soak parts in Complete Café solution for 1 minute. If parts cannot be removed, then dab a soft cloth into the Complete Café solution and use it to coat appliance part.

#### 3. DRY

Remove parts from solution and allow to **drain well and dry completely**. If the parts are not completely dry, dampness can lead to mold. Do not rinse. If parts were not removed from the appliance, wipe with a soft cloth and let air dry.

**AAA Business Supplies & Interiors may charge for service calls due to a failure to properly maintain, clean and sanitize the brewer.**

If you have any questions, please email [service@aaasolutions.com](mailto:service@aaasolutions.com) or call **800-821-4430**.